

ENVIRO-CORNER_{TM} SECTION PROPERTIES TABLE

EC7.5-43-6

6" WALL THICKNESS

Steel thickness: 43 mil (0.0451 in - 18 ga)

Flange Width: 3.25 in

Web Depth: 7.5 in

Fy: 33 ksi

Section Properties:

| | | | |
|------------|------------|------------------------|---|
| Gross: | I_{xx} : | 10.946 in ⁴ | |
| | S_{xx} : | 2.919 in ³ | |
| | A: | 1.243 in ² | |
| | r_x : | 2.967 in | |
| | r_y : | 2.448 in | |
| Effective: | I_{xx} : | 10.567 in ⁴ | (Deflection) |
| | S_{xx} : | 2.561 in ³ | (Flexure) |
| | A_e : | 1.172 in ² | (Effective Area at Fy) |
| | y_{cg} : | 3.948 in | (Distance to Neutral Axis from Top Compression Fiber) |

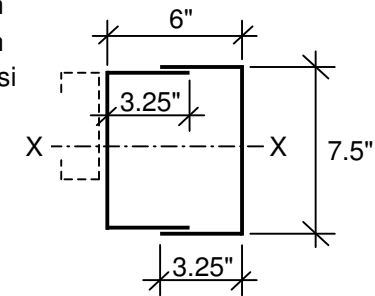

Notes:

1. Section properties are based on the 2001 NAS Specification.
2. Check End Reaction for Web Crippling.
3. Load bearing corner studs are to be designed for combined axial and bending loads by a qualified professional.
4. Strength increase due to cold work of forming has not been incorporated.
5. The effective Moment of Inertia has been calculated for deflection based on Procedure 1 of the 2001 NAS Specification by using the stress at the effective section modulus of the allowable bending moment.