

## ENVIRO-CORNER<sub>TM</sub> SECTION PROPERTIES TABLE

**EC7.5-54-6**

**6" WALL THICKNESS**

Steel thickness: 54 mil (0.0566 in - 16 ga)

Flange Width: 3.25 in

Web Depth: 7.5 in

Fy: 50 ksi

Section Properties:

Gross:	$I_{xx}$ :	13.594 in <sup>4</sup>	
	$S_{xx}$ :	3.626 in <sup>3</sup>	
	A:	1.555 in <sup>2</sup>	
	$r_x$ :	2.957 in	
	$r_y$ :	2.442 in	
Effective:	$I_{xx}$ :	13.163 in <sup>4</sup>	(Deflection)
	$S_{xx}$ :	3.205 in <sup>3</sup>	(Flexure)
	$A_e$ :	1.471 in <sup>2</sup>	(Effective Area at Fy)
	$y_{cg}$ :	3.936 in	(Distance to Neutral Axis from Top Compression Fiber)

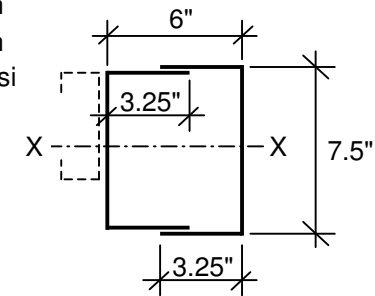

Notes:

1. Section properties are based on the 2001 NAS Specification.
2. Check End Reaction for Web Crippling.
3. Load bearing corner studs are to be designed for combined axial and bending loads by a qualified professional.
4. Strength increase due to cold work of forming has not been incorporated.
5. The effective Moment of Inertia has been calculated for deflection based on Procedure 1 of the 2001 NAS Specification by using the stress at the effective section modulus of the allowable bending moment.