

## ENVIRO-CORNER<sub>TM</sub> SECTION PROPERTIES TABLE

**EC7.5-97-6**

**6" WALL THICKNESS**

Steel thickness: 97 mil (0.1017 in - 12 ga)

Flange Width: 3.25 in  
 Web Depth: 7.5 in  
 Fy: 50 ksi

**Section Properties:**

Gross:	$I_{xx}$ :	23.387 in <sup>4</sup>	
	$S_{xx}$ :	6.241 in <sup>3</sup>	
	A:	2.75 in <sup>2</sup>	
	$r_x$ :	2.916 in	
	$r_y$ :	2.418 in	
Effective:	$I_{xx}$ :	23.387 in <sup>4</sup>	(Deflection)
	$S_{xx}$ :	6.055 in <sup>3</sup>	(Flexure)
	$A_e$ :	2.699 in <sup>2</sup>	(Effective Area at Fy)
	$y_{cg}$ :	3.799 in	(Distance to Neutral Axis from Top Compression Fiber)

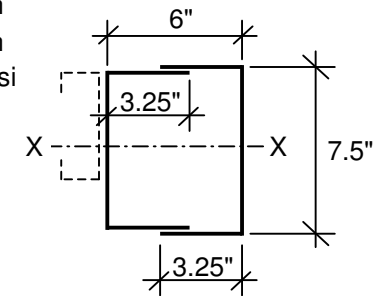

**Notes:**

1. Section properties are based on the 2001 NAS Specification.
2. Check End Reaction for Web Crippling.
3. Load bearing corner studs are to be designed for combined axial and bending loads by a qualified professional.
4. Strength increase due to cold work of forming has not been incorporated.
5. The effective Moment of Inertia has been calculated for deflection based on Procedure 1 of the 2001 NAS Specification by using the stress at the effective section modulus of the allowable bending moment.